

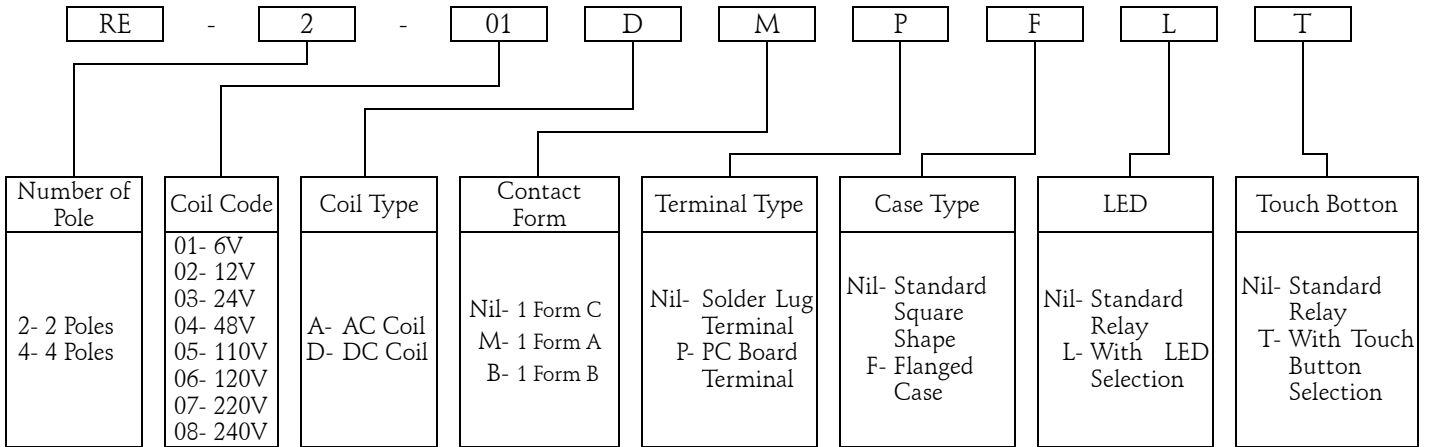

**Coil Specification (at 20°C)**

Coil Sensitivity	Coil Voltage Code	Nominal Voltage (VDC)	Nominal Current (mA)		Coil Resistance ( $\Omega \pm 10\%$ )	Power Consumption	Pull-In Voltage (VDC)	Drop-Out Voltage (VDC)	Max. Allowable Voltage (VDC)
			50 Hz	60 Hz					
RE 2-P & 4-P AC Coil	01	6	282.67	214.33	10	Abt. 1.0 to 1.3VA (60Hz)	80% Maximum	30% Minimum	110%
	02	12	106.20	94.85	40				
	03	24	52.80	45.45	160				
	04	48	23.65	19.95	600				
	05	110	12.45	10.25	3,400				
	06	120	16.75	14.33	3,400				
	07/08	220/240	6.18/7.24	5.08/5.85	13,600				
RE 2-P & 4-P DC Coil	01	6	150		40	Abt. 0.9 W	80% Maximum	10% Minimum	110%
	02	12	75		160				
	03	24	36.9		650				
	04	48	18.5		2,600				
	05	110	10		11,000				
	06	120	10.9		11,000				

**Ordering Information:**



## Dimension:

RE-2-P

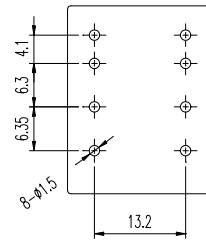
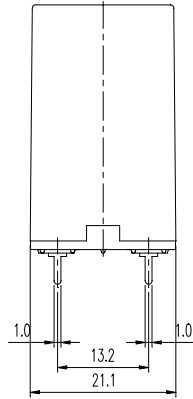
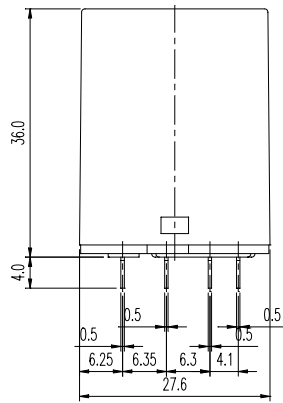

BOTTOM VIEW

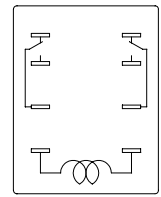

BOTTOM VIEW

RE-2

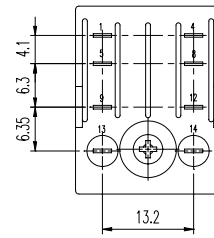
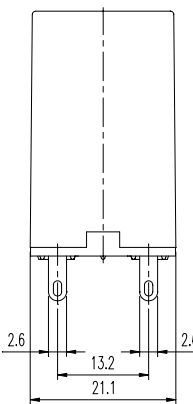
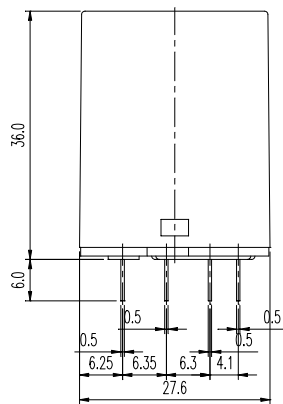

BOTTOM VIEW

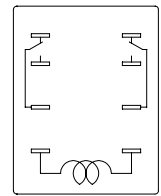

BOTTOM VIEW

RE-4-P

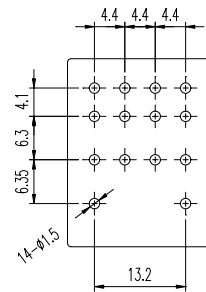
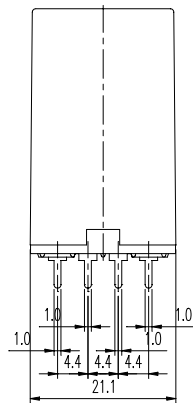
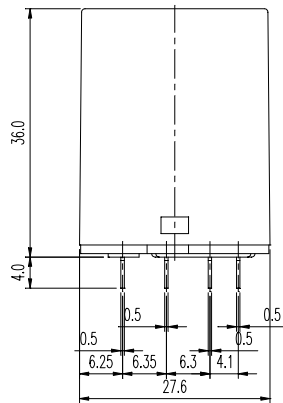

BOTTOM VIEW

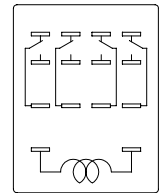

BOTTOM VIEW

RE-4

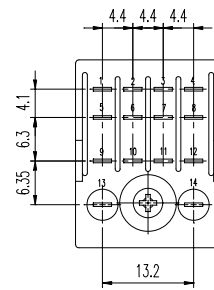
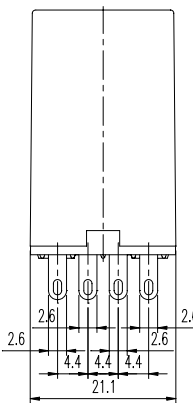
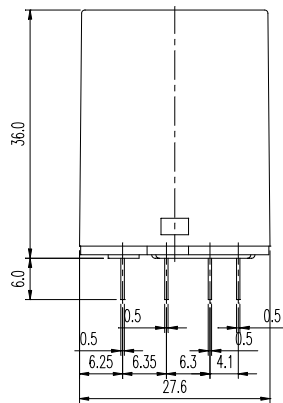

BOTTOM VIEW

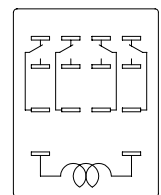

BOTTOM VIEW

RE-2-F

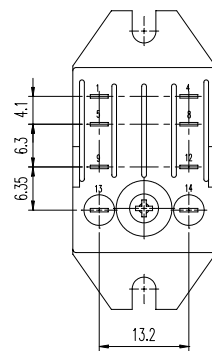
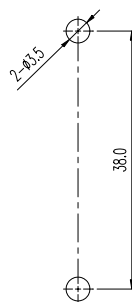
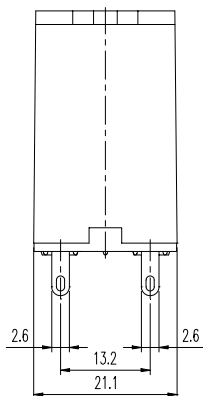
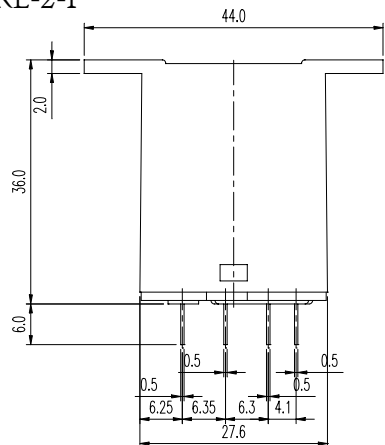

BOTTOM VIEW

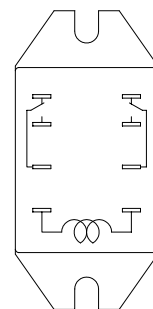

BOTTOM VIEW

RE-4-F

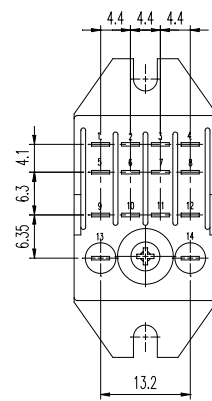
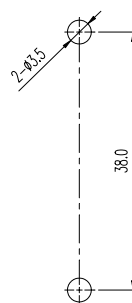
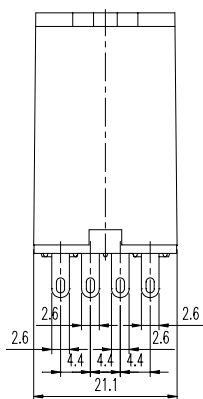
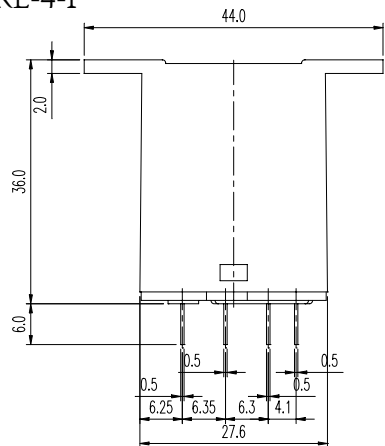

BOTTOM VIEW

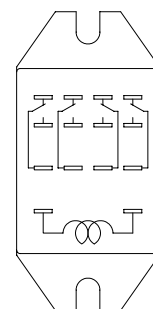

BOTTOM VIEW